

**\*PLEASE NOTE\***  
NON STANDARD LENGTH-28' LONG

\*8540\*

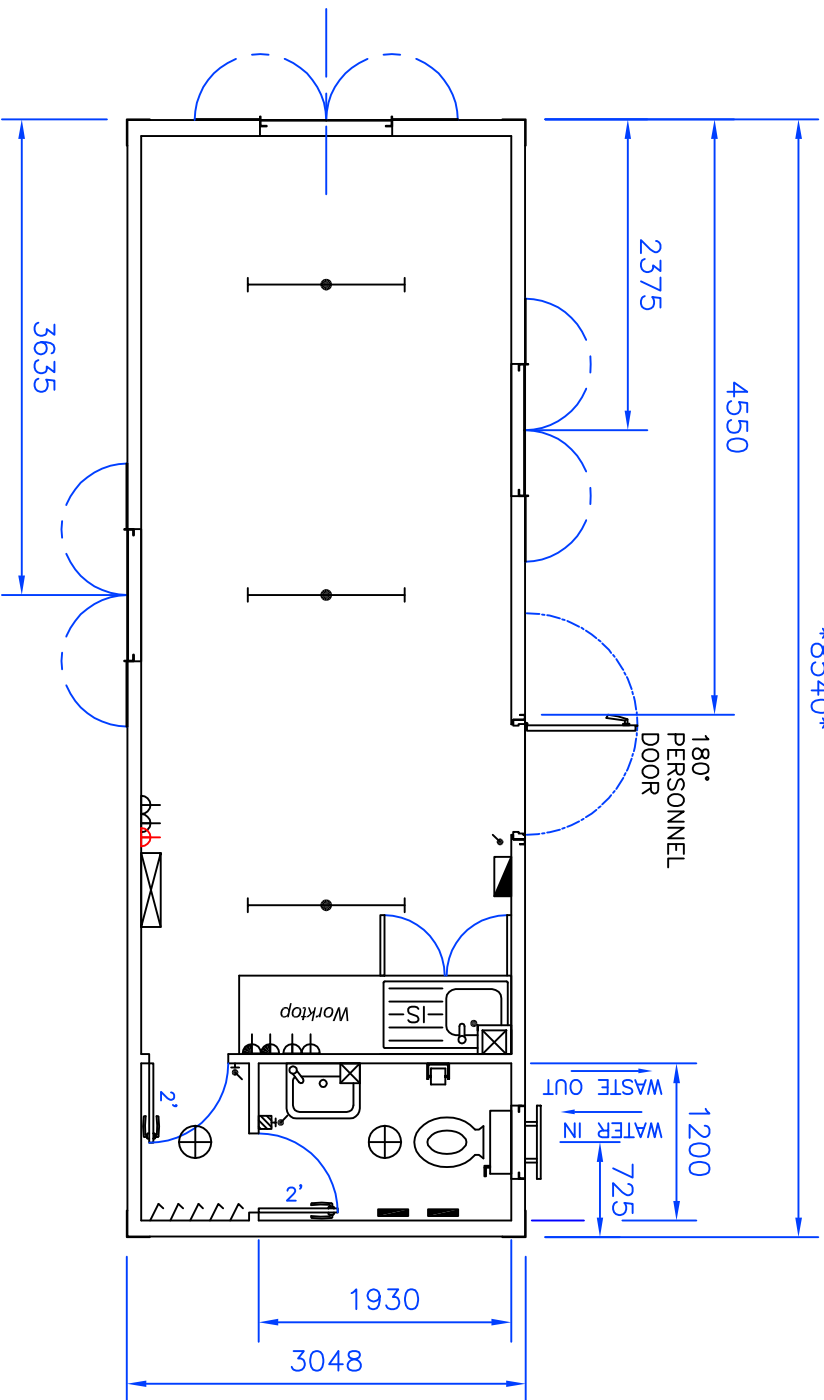

LINED USING EGB2001 & INSULATED.  
MONO-WHITE CEILING PANELS.  
WOODSTAIN TRIM  
'POLYFLOOR' VINYL FLOORING.

KEY TO SYMBOLS

	Consumer Unit
	Light Switch
	Light Pullswitch
	Fused Spur & Thermostat
	4' Fluorescent Light
	Bulkhead Light
	2' Tube Heater + Guard
	2kW Convecter Heater-Spur
	Twin Skt., 1000mm above F.F.L.
	Twin Skt., 300mm above F.F.L.
	3kw Instant Water Heater
	2kw 5ltr Water Storage Heater

APPROVAL BOX  
Customer:  
Signature:  
Name:  
Date:

ISSUE	DATE	DESCRIPTION
1	18/06/07	FIRST ISSUE

TITLE  
Mac Containers  
28'x10' Complex

**Mac Containers**

DRAWN	JT	DATE	18/06/07	DRG. No.	MAC_CX2810V02
APPROVED		DATE			
CHECKED		DATE			