

*** ALL LOCKS TO BE SUITED ***

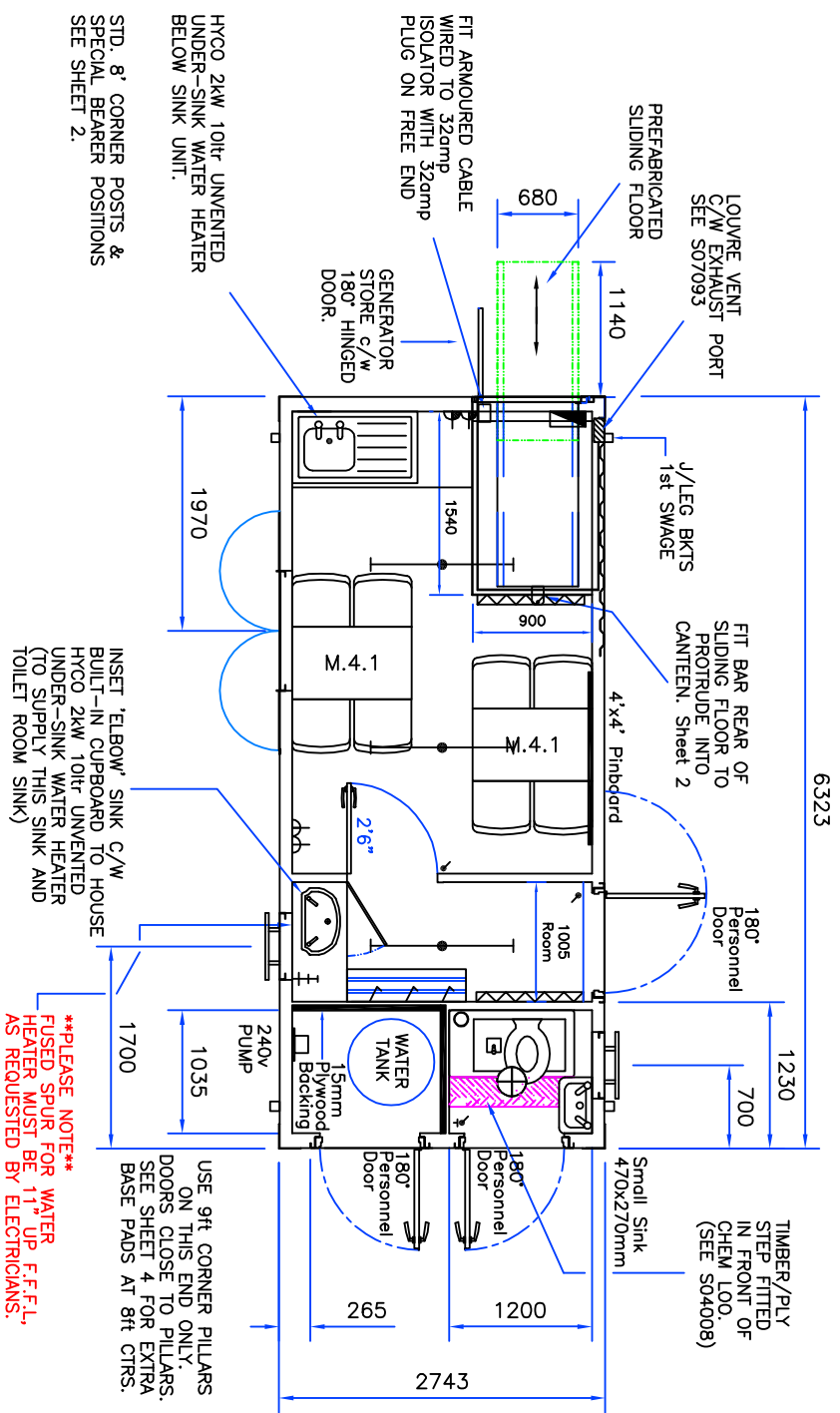

NOTE: SOCKETS TO BE WIRED AS RADIAL CIRCUIT (NOT RING FINAL)

END WALL BEHIND SINK, WORKTOP AND GENERATOR HOUSING PLUS FIRST PANEL BACK ALONG SIDE WALLS TO BE WHITE 'STELVATITE' PANELS REMAINDER OF UNIT TO BE LINED WITH EGB2001 & INSULATED. MONO WHITE CEILING PANELS AND WOODSTAIN TRIM. 'POLYFLOOR' VINYL FLOORING.

STD. 8' CORNER POSTS & SPECIAL BEARER POSITIONS SEE SHEET 2.
 INSET 'ELBOW' SINK C/W BUILT-IN CUPBOARD TO HOUSE HYCO 2kW 10ltr UNVENTED UNDER-SINK WATER HEATER (TO SUPPLY THIS SINK AND TOILET ROOM SINK)
****PLEASE NOTE**
 FUSED SPUR FOR WATER HEATER MUST BE 1" UP F.F.L. AS REQUESTED BY ELECTRICIANS.**

USE 9ft CORNER PILLARS ON THIS END ONLY. DOORS CLOSE TO PILLARS. SEE SHEET 4 FOR EXTRA BASE PADS AT 8ft CTRS.

KEY TO SYMBOLS

	Consumer Unit
	3' Oil Filled Radiator
	Twin Skt., 300mm above F.F.L.
	Twin Skt., 1000mm above F.F.L.
	4' Fluorescent Light
	Bulkhead Light
	Pullswitch
	Light Switch
	Earth Bond

****PLEASE NOTE**
 FIT HOOK & EYES TO DOORS ON END ELEVATION**

APPROVAL BOX

Customer:
 Signature:
 Name:
 Date:

2	04/10/07	Customer Request; 180° Doors Added
1	28/06/07	FIRST ISSUE

TITLE
 Mac Containers
 Welfare Unit

Mac Containers

DRAWN	JT	DATE	28/06/07	DRG. No.	MAC_OP2010V02
APPROVED		DATE		Sht. 1 of 5	
CHECKED		DATE			