

*** ALL LOCKS TO BE SUITED ***

PLEASE NOTE
ORDERING INFORMATION
OVERALL ROLLING FLOOR SIZE

GENERATOR STORE c/w 180°
HINGED DOOR, FIT CABIN
HOOK TO SECURE IN OPEN
POSITION. SEE SHEET 3.
C/W LOUVERE

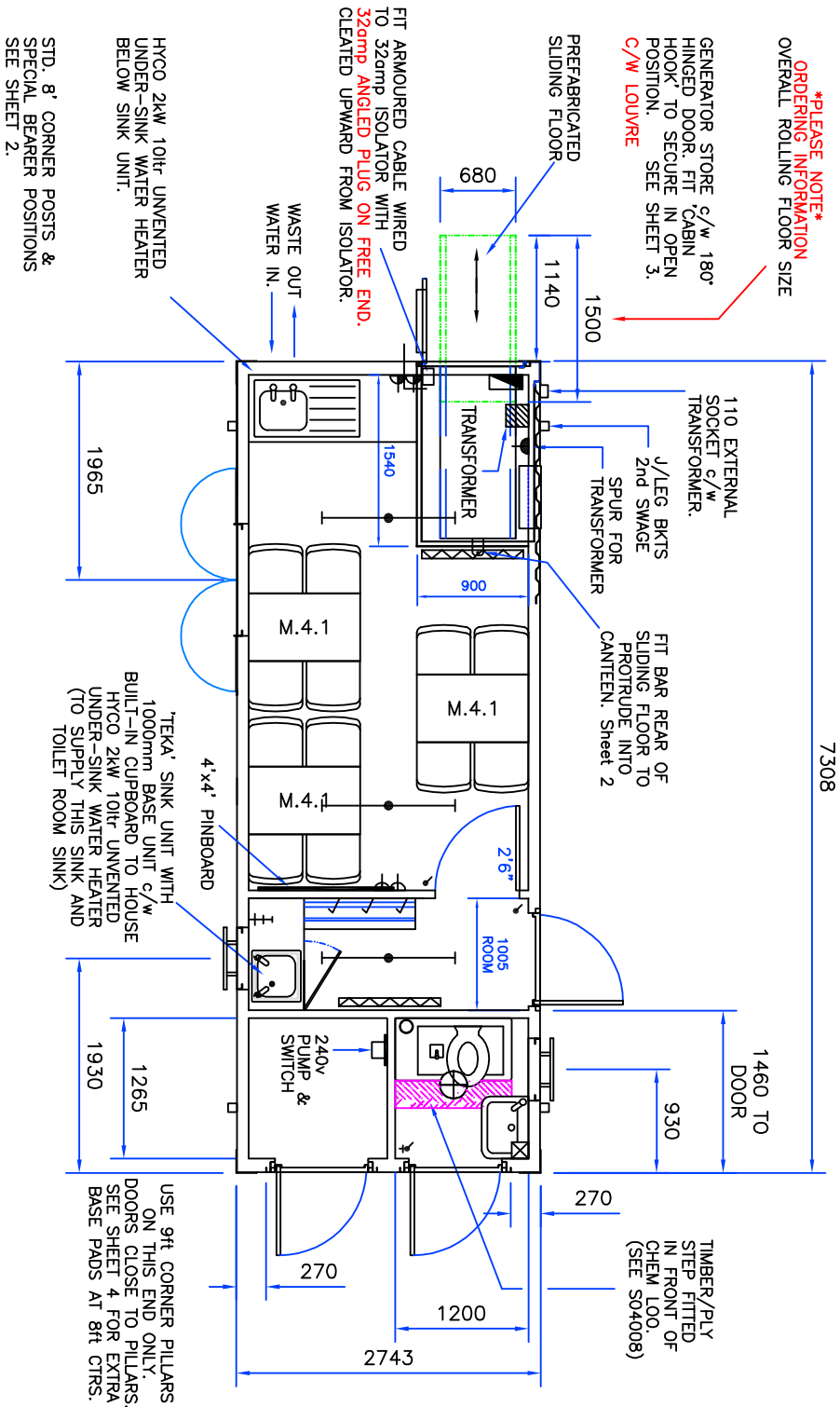

NOTE: SOCKETS TO BE WIRED AS
RADIAL CIRCUIT (NOT RING FINAL)
END WALL BEHIND SINK, WORKTOP AND GENERATOR HOUSING PLUS FIRST
PANEL BACK ALONG SIDE WALLS TO BE WHITE FACED 'STELVATTE' BOARD.
REMAINDER OF UNIT TO BE LINED WITH EGG2001 & INSULATED.
MONO WHITE CEILING PANELS AND WOODSTAIN TRIM.
POLYFLO® VINYL FLOORING.

3No 90° PERSONNEL DOORS
2No HIGH LEVEL WINDOWS
c/w MESH GUARDS.
1No STD. 3'x3' WINDOW
c/w STEEL SHUTTERS.

USE 9ft CORNER PILLARS
ON THIS END ONLY.
DOORS CLOSE TO PILLARS.
SEE SHEET 4 FOR EXTRA
BASE PADS AT 8ft CTRS.

KEY TO SYMBOLS

	Consumer Unit
	Pullswitch
	Light Switch
	Bulkhead Light
	4' Fluorescent Light
	3kw Instant Water Heater
	Oil Filled Radiator
	Twin Skt., 300mm above F.F.L.
	Twin Skt., 1000mm above F.F.L.
	Earth Bond

APPROVAL BOX

Customer:
Signature:
Name:
Date:

ISSUE	DATE	DESCRIPTION
1	20/08/08	FIRST ISSUE

TITLE
Mac Containers
Welfare Unit

Mac Containers

DRAWN	JT	DATE	20/08/08	DRG. No.	MAC_WU2409V01
APPROVED		DATE			
CHECKED		DATE			