

PLEASE NOTE
 UNIT TO BE FITTED WITH 2 OFF SINGLE PHASE CONSUMER UNITS
 ELECTRICAL EQUIPMENT TO BE DIVIDED EQUALLY

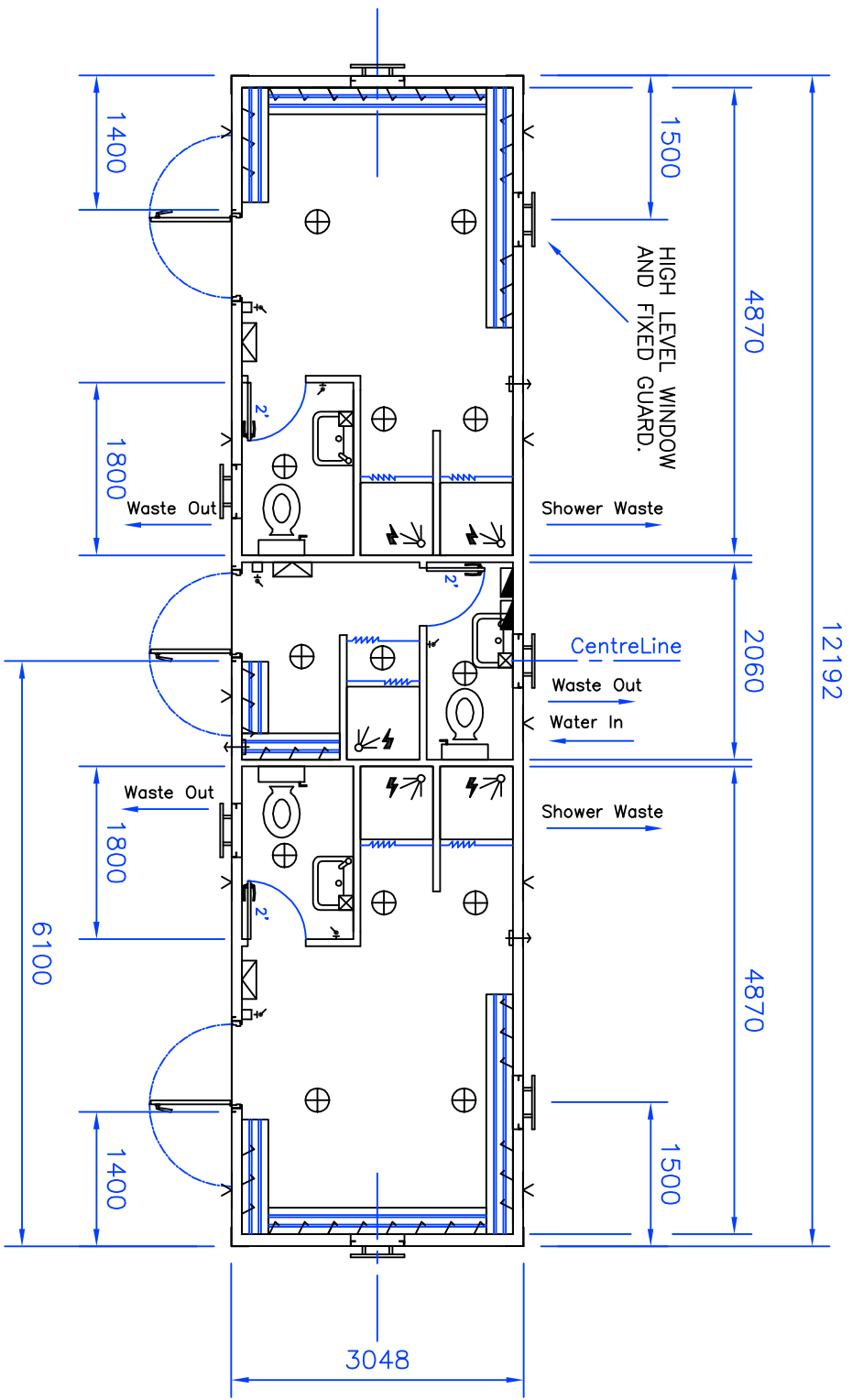

3No. 180" PERSONNEL DOORS.

LINED USING EGB2001 & INSULATED.
 'ALTRO' NON-SLIP VINYL FLOORING THROUGHOUT.
 MONO WHITE CEILING
 WOODSTAIN TRIM



KEY TO SYMBOLS

	Consumer Unit
	2.4kw Downflow Heater
	Fused Spur & Thermostat
	Bulkhead Light
	Light Pullswitch
	1kw Instant Water Heater
	Vent, 1High & 1Low Level
	Extraction Fan
	7.2kw Shower Unit

APPROVAL BOX
 Customer:
 Signature:
 Name:
 Date:

2	11/08/06	Customer Request; Layout Update
1	24/01/06	FIRST ISSUE
ISSUE	DATE	DESCRIPTION

TITLE
 Mac Containers
 40'x10' Toilet/Shower

Mac Containers

DRAWN	PB	DATE	DRG. No.
APPROVED		DATE	MAC_TS4010V01
CHECKED		DATE	